

Rear Suspension Tool

Ford Focus



**NEW
PRODUCT**

Description

Rear Suspension Tool for the rear Trailing Arm Bushes on Ford Focus 1.4 | 1.6 | 1.8 | 1.8Di | 1.8TDCi | 2.0 16v RS.

This tool is designed to fit in-situ saving time and money.

CONTENTS

Main Drive Bar (Replacement Part No.1192)
Thrust bearing Assembly
Removal sleeve
Installing sleeve

Packaging

Blow Mould Case

Section Within Catalogue

Running Gear Suspension

Page Number in Catalogue

3 (New products leaflet)

Additional Information

18 September 2008



5 018341 044374 >



Rear Suspension Tool

Ford – Focus

Rear Suspension Tool for the rear Trailing Arm Bushes on Ford Focus 1.4 | 1.6 | 1.8 | 1.8Di 1.8TDCi | 2.0 16v RS. This tool is designed to fit in situ saving time and money.

Removal

- 1 Remove shock absorber, lower mounting bolt, ABS brake sensor etc and wedge the lower arm in place to gain access to the bush.
- 2 To ensure the correct alignment is achieved mark the inner wing of the bush against the arm.
- 3 Lubricate generously the stud threads and bearing assembly before and during use.
- 4 To remove the old bush, assemble tool as shown in (Fig 1) using removal sleeve.
- 5 The tool should be pushing in to the centre from the outside (Fig 1)
- 6 Screw up the Main Drive Bar until the Thrust Bearing assembly makes contact with the bush.
- 7 Continue to tighten slowly using a 21mm spanner or ratchet on the hex end.
- 8 If the bush remains stubborn, re-lubricate and try again.
- 8 Reassemble the suspension ensuring the arm is correctly aligned.
- 9 Clean off tool and re-lubricate

Contents

- A Main Drive Bar
- B Thrust bearing Assembly
- C Removal sleeve (Silver)
- D Installing sleeve (Gold)

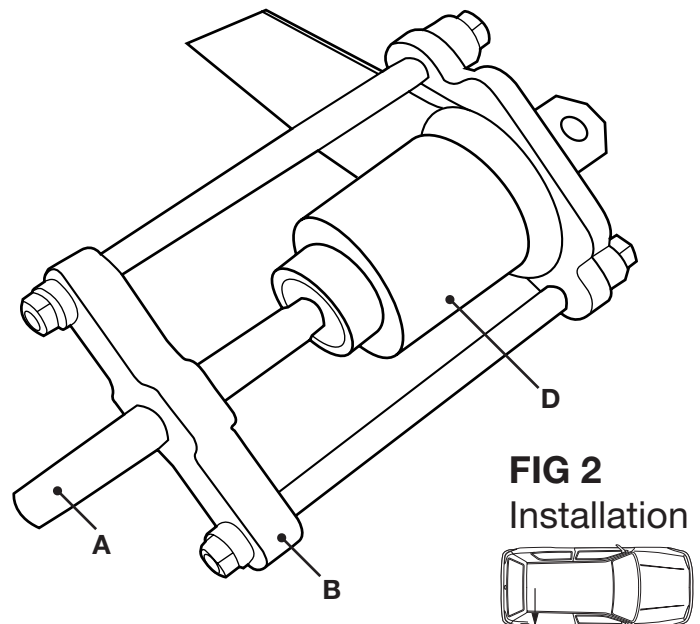
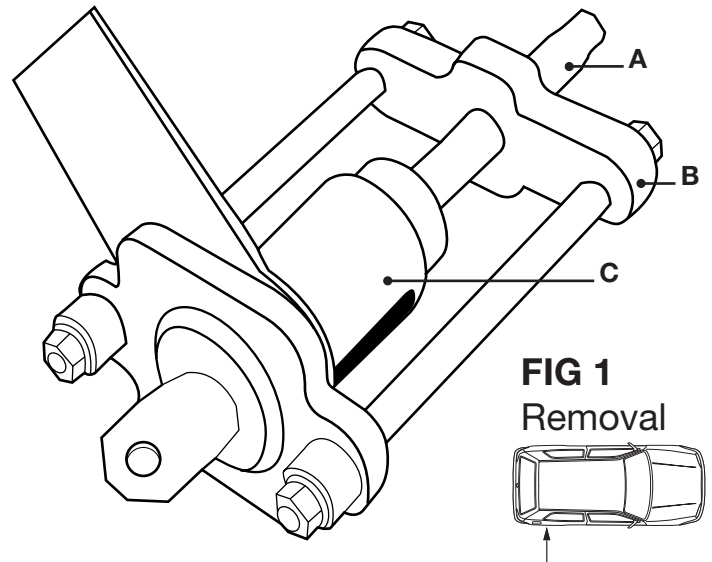

Installation

- 1 Re-assemble the tool using the installation sleeve (Fig 2)
- 2 Clean the bore of the arm and re-lubricate the Thrush bearing assy.
- 3 Position the slot on the installation tool facing towards the rear of the car. The tool should be pushing from the centre of the car to the outside (Fig 2)
- 4 Ensure the bush is aligned with markings taken before removal and the bottom edge of the installing sleeve corresponds with the contoured shape of the trailing arm.
- 5 Hand tighten as before until the Thrust Bearing contacts the new bush.
- 6 Tighten using the 22mm tool until the new bush moves into position.
- 7 Continue to tighten, maintaining alignment until bush is re-housed into pre marked position.