



Front Control Arm Bush Tool BMW Mini!

LASER®

Instructions

4767



www.lasertools.co.uk



Distributed by The Tool Connection Ltd
Kington Road, Southam, Warwickshire CV47 0DR
T +44 (0) 1926 815000 F +44 (0) 1926 815888
info@toolconnection.co.uk www.toolconnection.co.uk

Guarantee

This item contains consumable elements and are **NOT** covered by the Tool Connection Guarantee. For spares contact our service department direct on: **+44 (0) 1926 818186**.

For replacing the rubber bush mounts (hydro-mounts) on the left and right front axle control arm in-situ. Saving time and money.

Application

BMW Mini R50, R53 (Mini Cooper) W10, W17, W11

Bush replacement no: 31 12 6 757 561/562

Instructions – Extraction

1. Fully grease the Force Nut and Bar before and after every use
2. Assemble tool using 6 | 7 | 8 | 1 | 2 through the existing bush and control arm
3. Attach item 3 at other end of bush, onto Force bar
4. Using a 24mm socket (air tools not recommended) draw the old bush into the Extraction Sleeve (2)

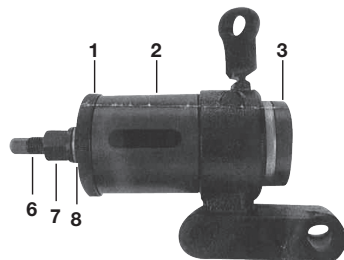

Instructions – Installation

1. Re-grease the Force Nut and Bar
2. Check the correct direction for inserting the new Bush
3. Insert the Force bar through the new Bush
4. Attach through Control Arm and through Item 5
5. Add bearing Washer
6. Attach Force Nut and tighten with 24mm socket (air tools NOT recommended)

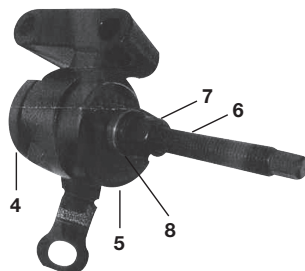

Contents

Required for Extraction of Bushes

- 1/2. Extraction Sleeve (with knurled edge and viewing slit)

3. Insert press sleeve
6. Force Bar (Replacement Part 1758)
7. Force Nut (Replacement Part 1759)
8. Bearing Washer

Required for Installation of New Bush

4. Installation Receive Sleeve
5. Installation Press Sleeve
6. Force Bar (Replacement Part 1758)
7. Force Nut (Replacement Part 1759)
8. Bearing Washer

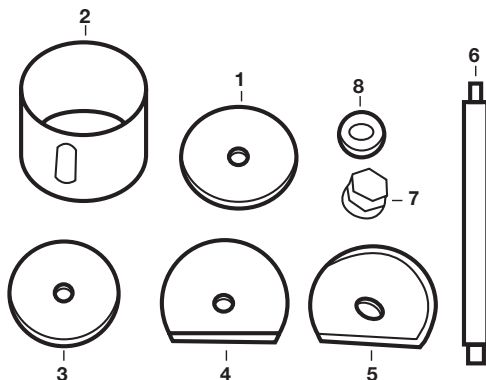

Due to the nature of this product the Force Nut and Bar are consumable and not therefore covered by the Tool Connection guarantee.

Spare parts can be obtained from your Motor Factor/Car Accessory Shop.